

## Amazing Mazes

### Supplies Needed

- Graph Paper
- Pencil
- Black Pen or Marker

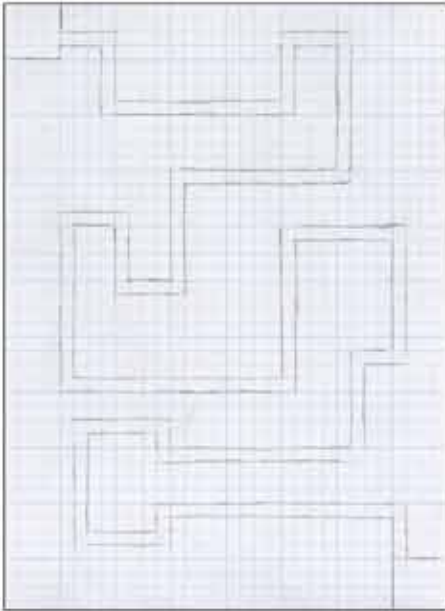

### Step 1

Gridded paper is terrific for drawing mazes. For a simple maze, use 4x4 grid paper. For a more complex maze, use 8x8 grid paper. With a pencil, draw a start and finish box for your maze on a piece of grid paper. Draw a path from the start box to the finish box. Leave some spaces open for gateways to more paths.

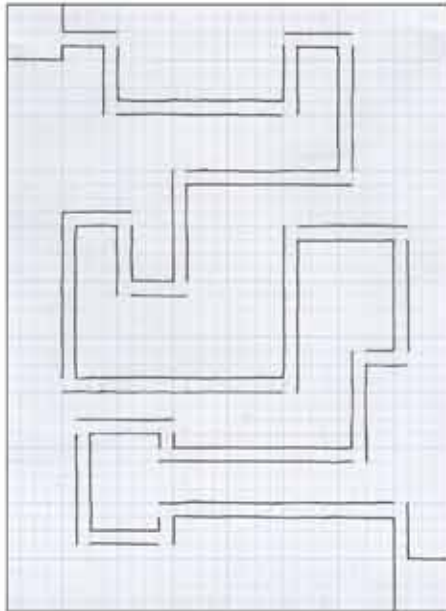

### Step 2

Trace over the path with a black pen or fine point marker.

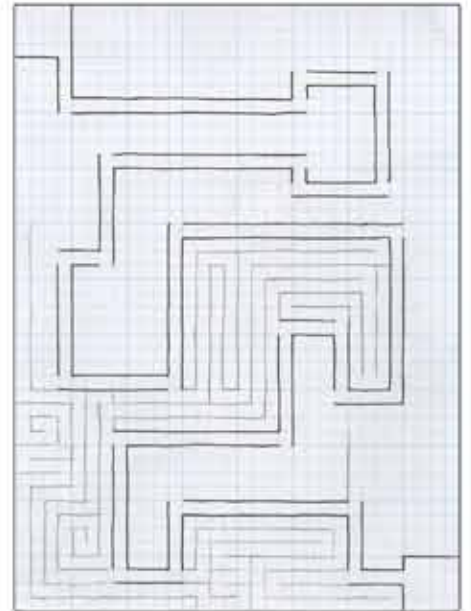

### Step 3

Using the open spaces, pencil in more paths, making sure they finish in dead ends.

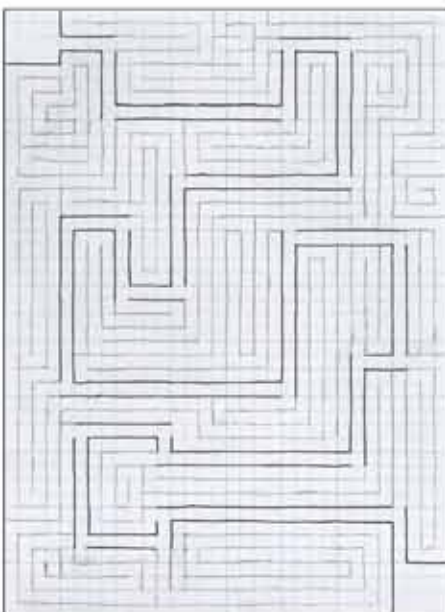

### Step 4

Continue filling the open spaces with more paths.

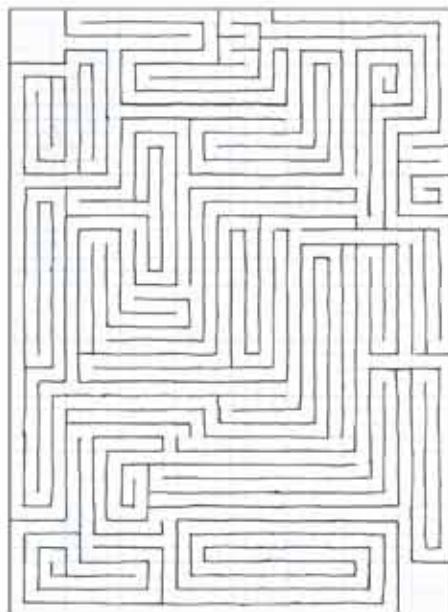

### Step 5

Trace over the false paths with the pen or marker. Your maze is now ready to solve!

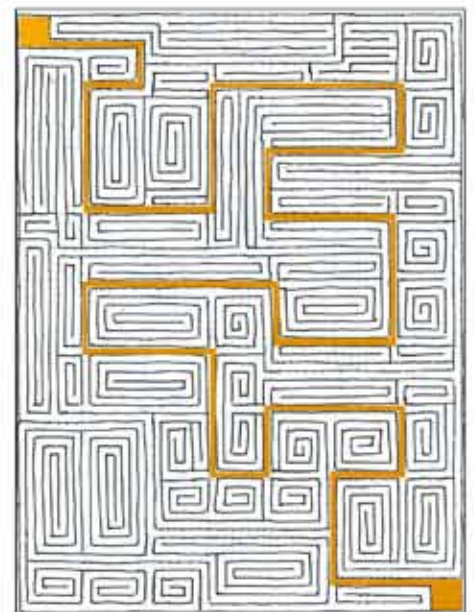

### Step 6

Make a photocopy and use a brightly colored marker to fill in the solution path.